

WISENET

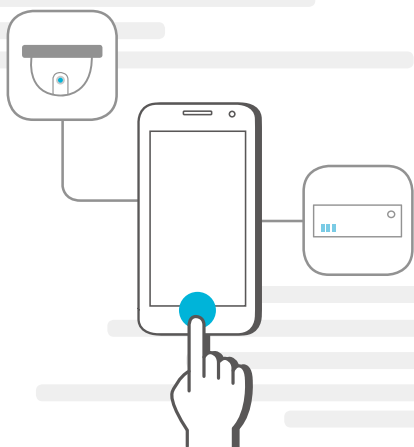

v1.4

WISENET mobile

User Manual



REGISTRATION

Registration

Auto Search for Devices

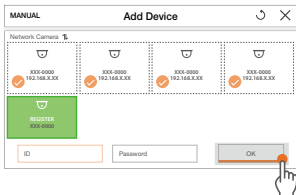

When the smartphone and the device are connected to the same Wi-Fi network

1. The list of devices that have been found will appear automatically.
 - When clicking [1.], you can select the method to sort the device list.
2. Enter the ID and the password, and click <OK>.
 - Devices that use the same ID and password can be added immediately.
3. Adding devices is complete.

Adding Devices Manually

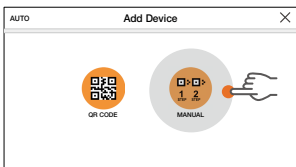

1. Click the manual button.
2. Enter the connection information, and click <OK>.
3. Adding devices is complete.

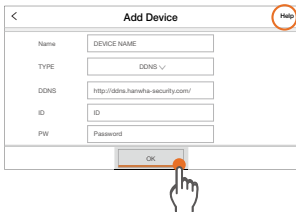

An explanation for each item is provided.

Adding Devices using a QR Code

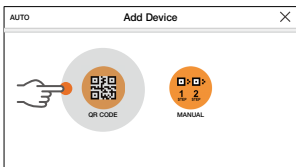

When the device has a QR code sticker attached

1. Click the QR code item.
2. Scan the QR code of the device with the smartphone.
3. Enter the ID and the password, and click <OK>.
4. Adding devices is complete.

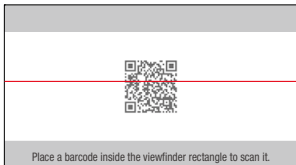



LIVE MONITORING

Live Monitoring Main Screen and Button Description

XXX-0000 - CAM01

When double-tapped, it will switch to 1-channel mode.

Split screen 1, 4, 9, 16

Add to My Channels
(It will be displayed on the top of the channel list)

Change channel

It is added to My Channels when the button [★] on the bottom of the live main channel is clicked, and it will be displayed on the top of the channel list.

CHANNEL LIST

MY CHANNELS

★ #1	★ #2	★ #3	★ #4
3CH	16CH	30CH	41CH

NVR

CAM 01	CAM 02	CAM 03	CAM 04	CAM 05	CAM 06	CAM 07
CAM 08	CAM 09	CAM 10	CAM 11	CAM 12	CAM 13	LIVE



LIVE MONITORING

1-Channel Mode Screen and Button Description

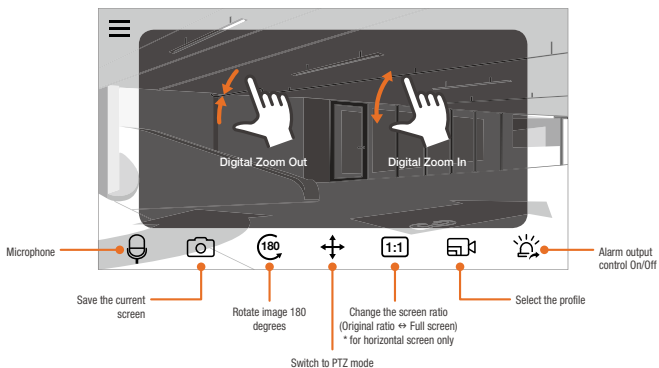

! Individual features may vary depending on the model.

PTZ Mode

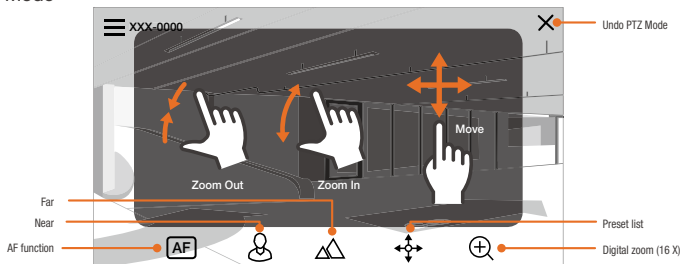

! If you keep your hand on when using pan tilt drag, it will keep moving in that direction.

! Individual features may vary depending on the model.

Fisheye Mode

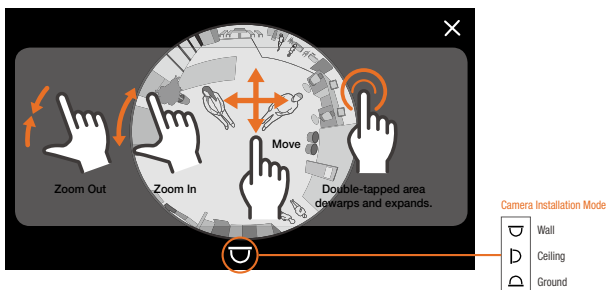



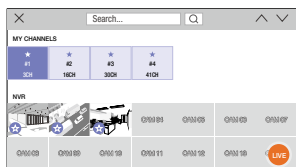

CHANNEL LIST

Channel List Screen



1. Move to the channel list by clicking [] on the top right of live monitoring.
2. Channel list can be searched when [] on the top right of the channel list screen is clicked.

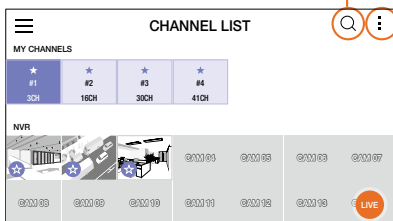

Press the button to move to the corresponding function.

1 Adding New Devices

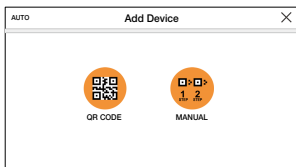

2 Modify Channel Information

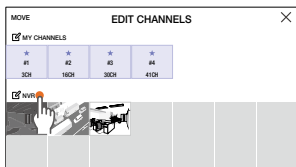

3 Showing the Device Name/Channel Name

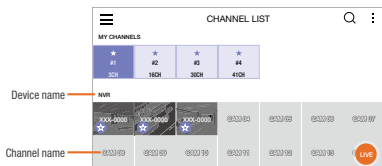

! When editing/deleting the connection information
Select the channel (thumbnail tile) if using the **Camera**.
Select the device name if using **NVR/DVR**.



SEARCH & PLAYBACK

Moving to the Playback Screen

From the Menu Button



In Live Monitoring screen

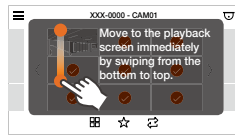

This works only from main view (refer to page 9).

Searching by Date/Time and Event

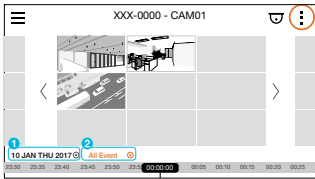

When the button is clicked, the multi-playback button and the layout change button are displayed.

1 Date/Time Search



2 Event Search

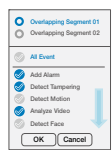

Only the dates with a saved image will be shown.

Timeline Screen Description in Detail

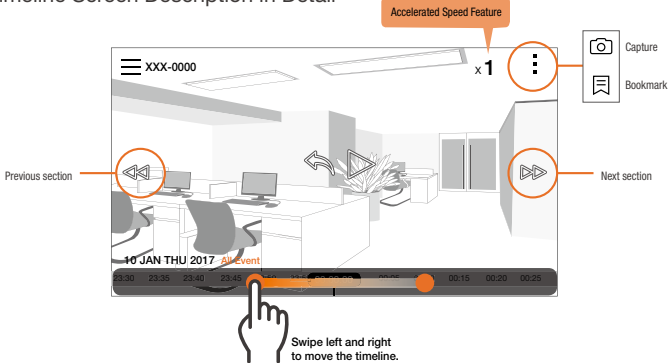

Searching the Bookmark

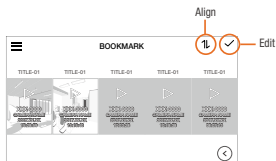



SEARCH & PLAYBACK

Event List

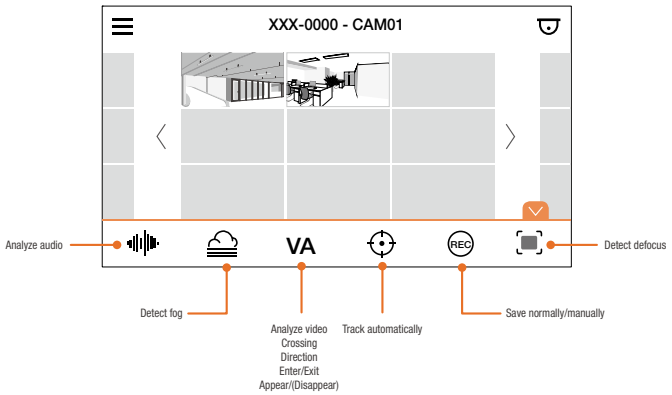
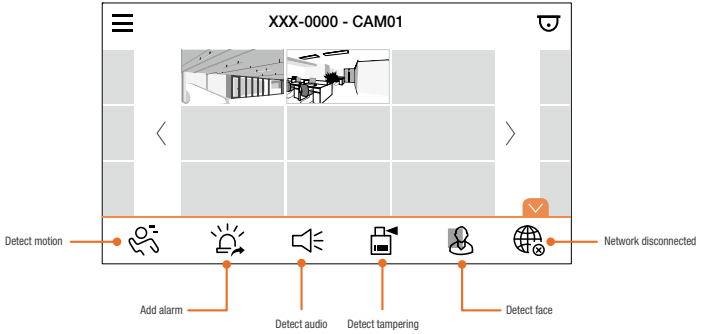

! Event types may vary depending on the model.



PUSH NOTIFICATION

Setting and Receiving Push Notifications

Settings

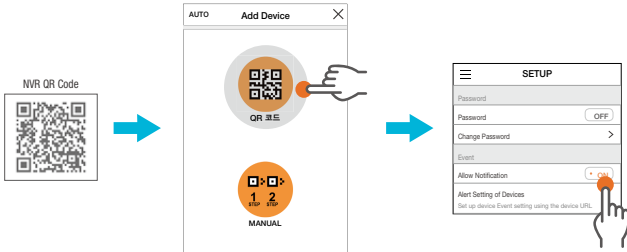

1. Register the QR code attached on NVR.
 - An NVR registered using a QR code can use push notifications.
2. When the registration is complete, set the **<Allow Notification>** item to **<ON>** after going to the settings screen.
3. Set the device to **<ON>** in the **<Device Setting>** item .

Receiving Push Notifications

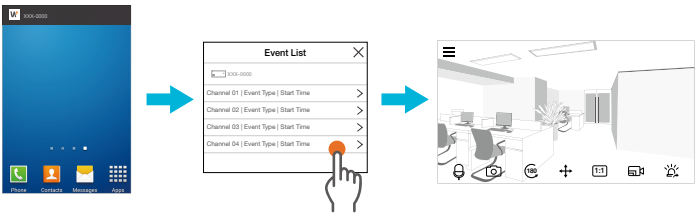

1. A push event receiving screen will appear when an event occurs.
 - It can be received after the **<Allow Notification>** item has been set in the Settings screen.
 - The view can vary according to the Event Push Notifications style the user has set in the mobile terminal.
2. Click on the event in the push event receiving screen.
3. It moves to the selected channel after running the app when the event is selected.



APPENDIX

Using Scenario



Full & Detail view rule



Head Office

6, Pangyo-ro 319 beon-gil, Bundang-gu, Seongnam-si,
Gyeonggi-do, 463-400 Rep. of KOREA
Tel : +82.70.7147.8753 Fax : +82.31.8018.3740
www.hanwha-security.com

Hanwha Techwin America

500 Frank W. Burr Blvd. Suite 43 Teaneck, NJ 07666
Toll Free +1.877.213.1222 Direct +1.201.325.6920
Fax +1.201.373.0124
www.hanwhasecurity.com

Hanwha Techwin Europe

Heriot House, Heriot Road, Chertsey, Surrey, KT16 9DT, United Kingdom
Tel +44.1932.57.8100 Fax +44.1932.57.8101
www.hanwha-security.eu
