

CA470 RANGE ADDRESSABLE MANUAL CALL POINTS INSTALLATION INSTRUCTIONS

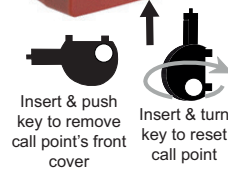
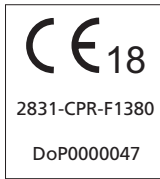

Product Description

The CAST CA470 range of addressable manual call points are compatible with C-TEC's CAST ZFP/XFP panels and other CAST compatible fire panels.

The call points have the following features:

- Fully compliant with EN 54-11 and EN 54-17 (Part No. CA470).
- Programmed and addressed via the fire panel, or CAST Hand-Held Programmer (CAPROG).
- On-board, bi-directional, short-circuit loop isolator (SC-Isolator).
- Can be either surface or flush mounted.
- Resettable plastic element, therefore glass does not need to be replaced.
- Supplied with combined test/removal key.
- For weatherproof applications, the range also includes an IP67 rated version (Part No. CA47067).
- Optional transparent vandal-resistant hinged covers are also available.

The following variants are available:

Part No.	Description
CA470 *	Addressable Universal Manual Call Point, Red (CAST) supplied with Flush Mounting Plate
CA47067	Addressable IP67 Manual Call Point, Surface Mounted, Red (CAST)
CA470Y	Addressable Manual Call Point, Surface Mounted, Yellow (CAST)
CA470GR	Addressable Manual Call Point, Surface Mounted, Green (CAST)
CA470B	Addressable Manual Call Point, Surface Mounted, Blue (CAST)
CA470W	Addressable Manual Call Point, Surface Mounted, White (CAST)
Accessories	BF470SK (Spare Test Key), BF470SC (Protective Cover, Branded 'LIFT TO OPERATE'), BF470SCB (Protective Cover, Blank)

* Approved to EN 54-11 & EN54-17

Installation

Ensure the call points are installed in accordance with applicable local and/or national regulations. Use the combined test/removal key to remove the call point's front and access the unit's fixings. For surface mounting, fit the back box (supplied) to a wall using 4 x screws (supplied) in the mounting slots provided. Run the loop cables into the back box. Two cable knockouts are provided on the rear, plus 2 x 3 pre-marked points on both the top and bottom of the back box. For flush mounting, use the supplied flush mounting plate with a suitable single gang, back box, e.g. RS Stock No. 776-8429.

For the IP67 version (Part No. CA47067), ensure only the back box supplied is used when wall mounting the unit. To protect against ingress, the front moulding is sealed internally to the back box by a gasket that is securely compressed by the screw fixings. The back box has cable entry via 20mm glands and can be mounted with either the single or double entry holes at the top.

Operation

Press anywhere in the target area to activate and a red alarm ring LED will illuminate the call point's face to confirm a signal has been sent. When activated, a reflective yellow and black striped indicator appears at the bottom of the operating window. The photoluminescent operating window will remain visible for up to 5 minutes in poor lighting conditions. Reset the call point using the combined test/removal key (supplied).

Connections

Ensure all wiring conforms to applicable local and/or national regulations.

Use the combined test/removal key (supplied) to remove the call point's front cover and access the electrical connections. The call point has a fixed, loop connector block comprising four terminals (2 x Loop In and 2 x Loop Out) that can accept 0.25 mm² to 2.5 mm² fire rated cable. Correct polarity must be observed.

CA470 Terminal	Function
1 +	+Ve
2 +	+Ve
3 -	-Ve
4 -	-Ve

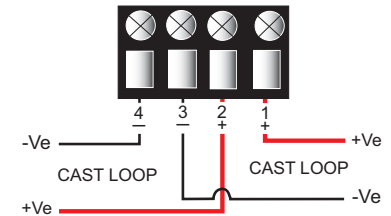

Technical Specification

Description:	CA470 Range Addressable Manual Call Points
Certified Standards:	EN 54-11:2001 + A1:2005 (Manual call points); EN 54-17:2005 (Short-circuit isolator)
LPCB Certificate Number:	176h * (Part No. CA470)
LPCB Reference Number:	176h/01 * (Part No. CA470)
CPR Certificate Number:	2831-CPR-F1380 * (Part No. CA470)
Declaration of Performance (DoP):	DoP0000047 *
Communication Protocol:	CAST (C-TEC)
Operating Voltage:	22-40 Vdc (loop powered)
Quiescent Current:	370 µA
Active Current (Typical):	< 5.0 mA
LED Indicator:	Steady Red (when operated); Flashing Red (when polling)
Dimensions (W x H x D):	88 x 87 x 61 mm (surface type); 118 x 110 x 42 mm (flush type)
Weight:	160 g (flush type); 180 g (surface type)
Material:	ABS polycarbonate and glass fibre window
IP Rating (EN 60529):	IP42 (CA470 range); IP67 (CA47067 version only)
Operating Temperature:	-10°C to +55°C
Humidity:	Maximum 95% RH (non-condensing)

* Certificates and DoPs available for download on C-TEC's website

EN 54-17 SC-Isolator Specification (Controllable Isolator)

Maximum Loop Voltage (V max):	40 Vdc
Nominal Loop Voltage (V nom):	40 Vdc
Minimum Loop Voltage (V min):	22 Vdc
Maximum Current Device Isolates, switches from closed to open (I_{so} max):	55 mA
Minimum Current Device Isolates, switches from closed to open (I_{so} min):	15 mA
Maximum Rated Continuous Current with switch closed (I_c max):	1 A
Maximum Rated Switching Current under short circuit conditions (I_s max):	1.6 A
Maximum Leakage Current with switch open (I_L max):	20 µA
Maximum Series Impedance with switch closed (Z_c max)	100 mohms



Manufacturer: Computationics Limited (C-TEC), Challenge Way, Martland Park, Wigan, Lancashire WN5 0LD. www.c-tec.com
E&OE. No responsibility can be accepted by the manufacturer or distributors of these devices for any misinterpretation of this instruction, or for the compliance of the system as a whole. The manufacturers policy is one of continuous improvement and we reserve the right to make changes to product specifications at our discretion and without prior notice.